

**PEDANA PASSEGGERO DESTRA  
PASSENGER'S R.H. FOOTBOARD**

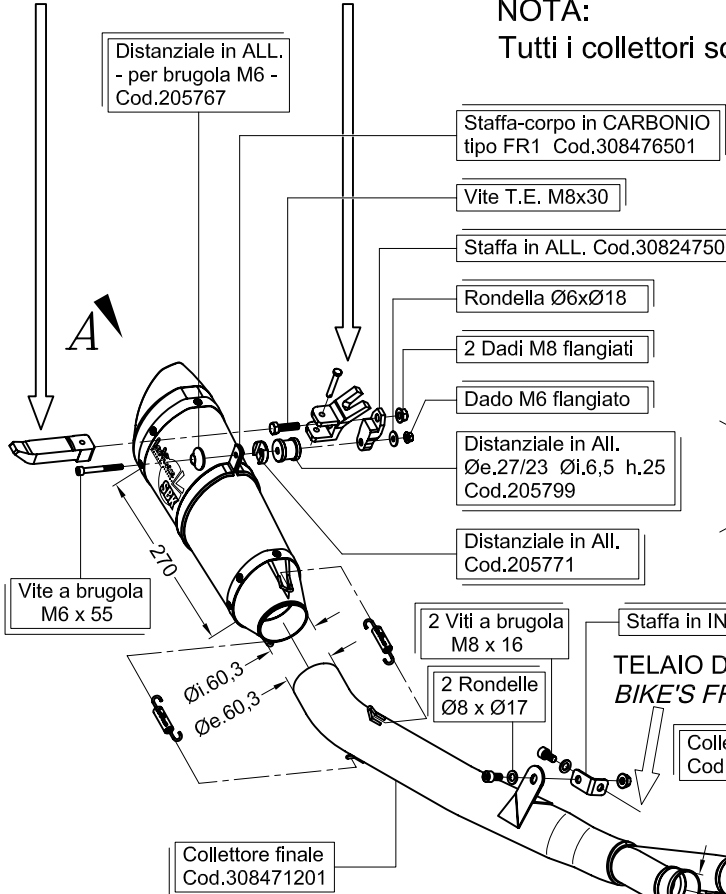

**NOTA:**  
Tutti i collettori sono in INOX

Collettori primari

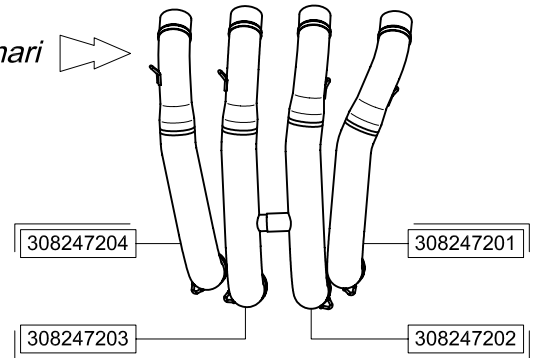

**CARTER METALLICO ORIGINALE  
- DA RIMUOVERE DEFINITIVAMENTE -  
ORIGINAL METALLIC HEAT-SHIELD  
- TO REMOVE DEFINITELY -**

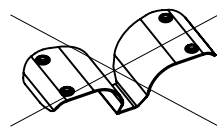

4 Fascette in plastica  
- per fissaggio cavi valvole di scarico -

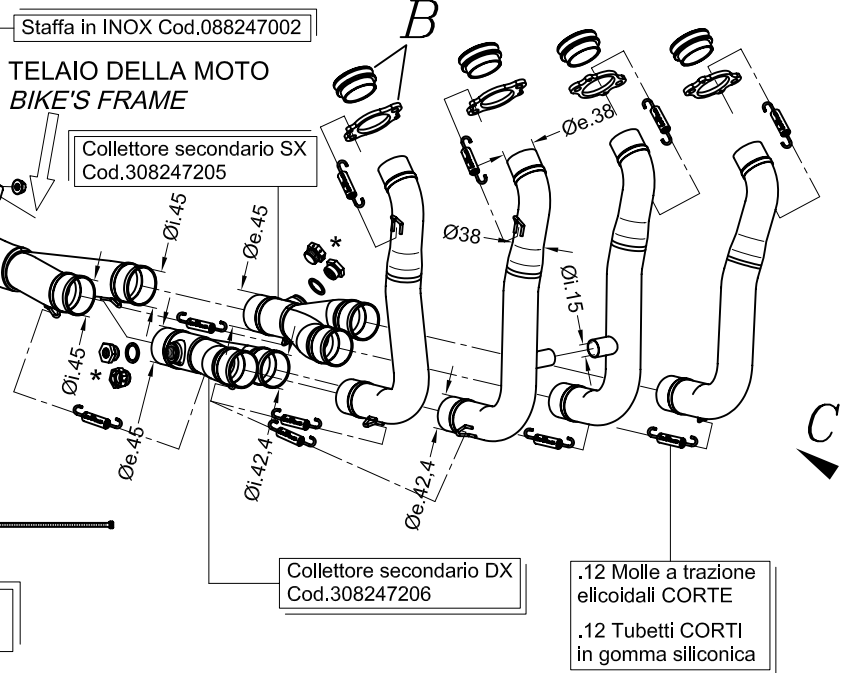
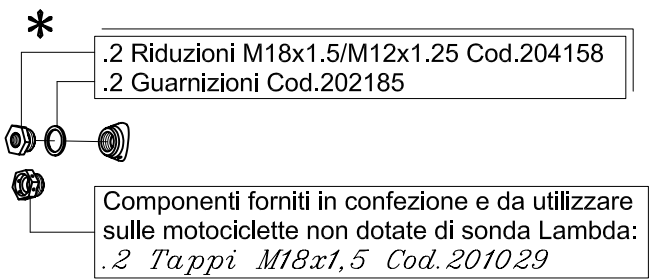

*BMW S 1000 RR i.e. ('10/'11)*

*Versione "STRADALE" (con pedane passeggero)*

Art.8471 Impianto completo SBK 4/2/1 << FACTORY R >> CARBONIO - Pass. STANDARD  
**RACING**

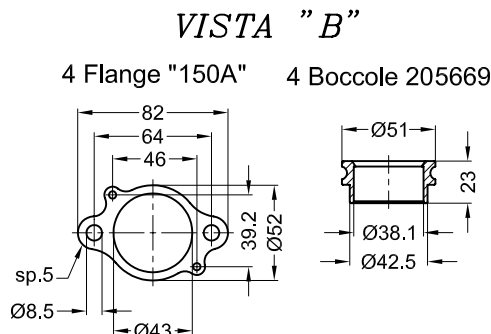
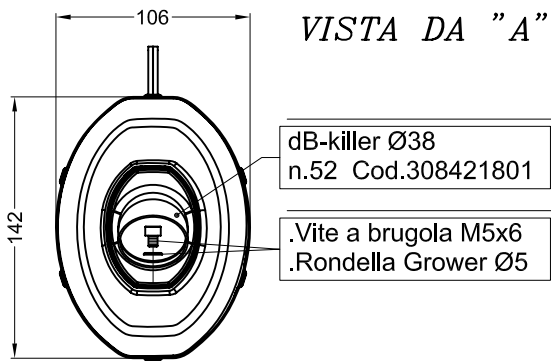

Collettori primari

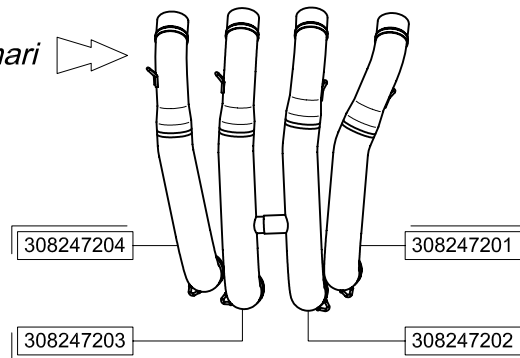

NOTA:  
Tutti i collettori sono in INOX

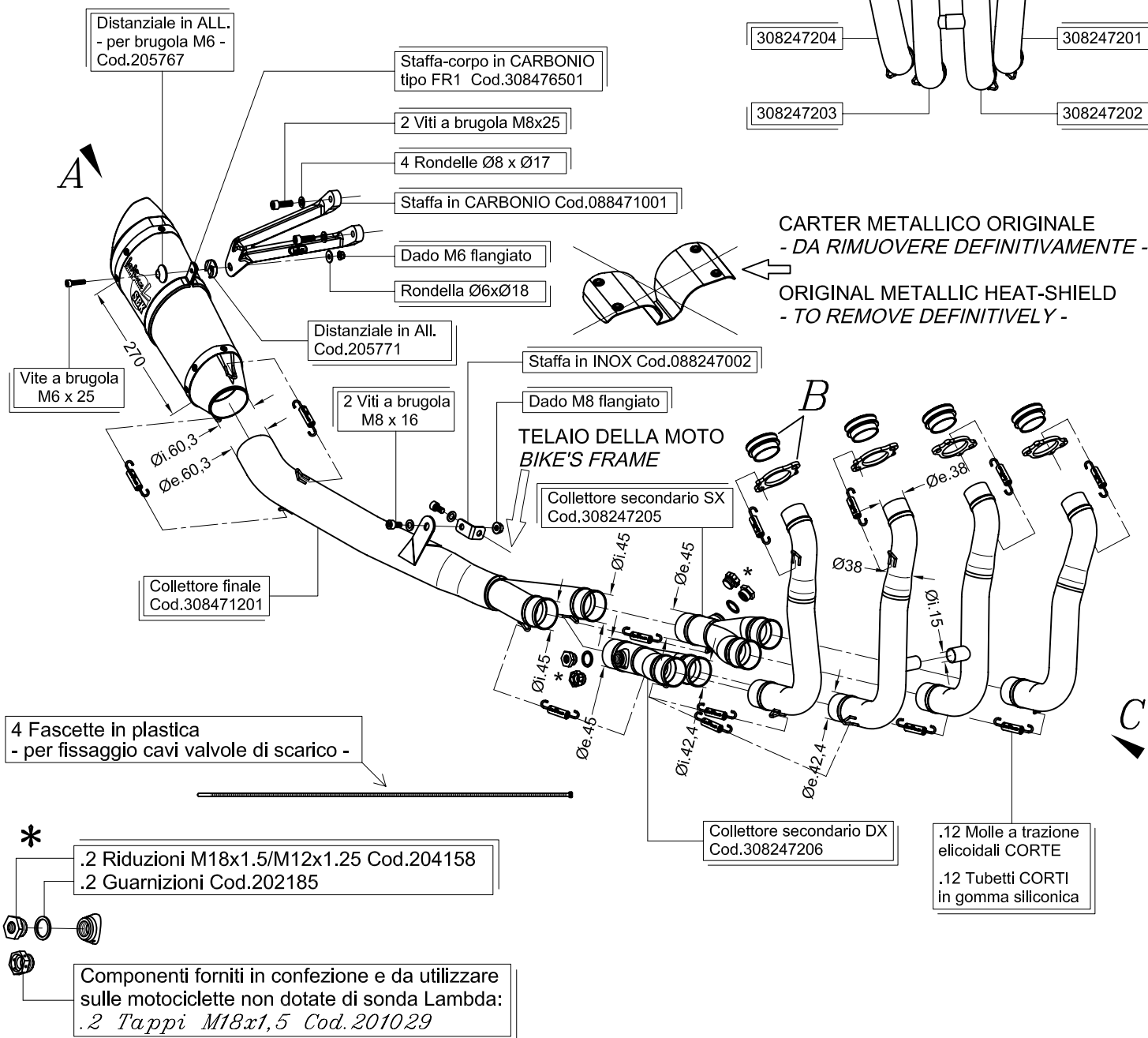

*BMW S 1000 RR i.e. ('10/'11)*

*Versione "MONOPOSTO" (senza pedane passeggero)*